

HAND WATER PUMP CAST IRON Type A, RETRO





A80 and A90

Hand Water Pump

- + Ornamental garden feature
- + Few installation
- + Easy to use

Data

Pumps body in cast iron
Adjustable hand lever in steel
Self-priming up to 8 m
Plunger 80 or 90 mm
Inlet diameter : 33/42 - 1"¼
A80 Flow rate (plunger 80 mm) : 20 to 30 l/mn
A90 Flow rate (plunger 90 mm) : 30 to 40 l/mn
A80 : 4,5 Kg A90 : 5Kg

Construction

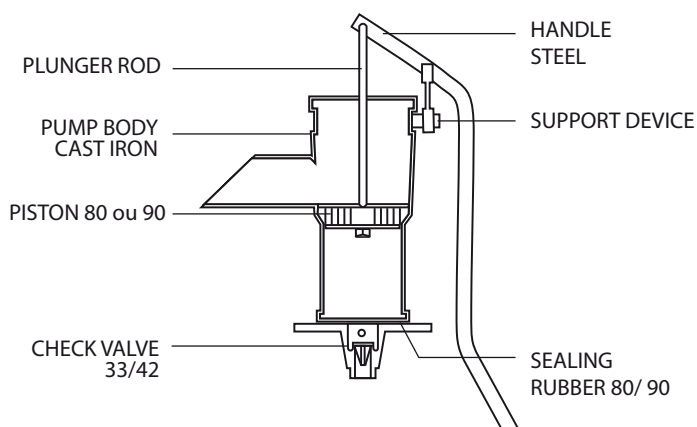

Dimensions

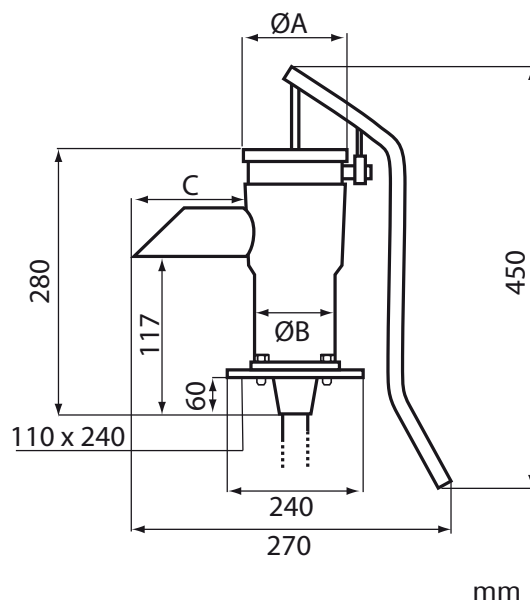

A80	A90
A=Ø100	A=Ø110
B=Ø87	B=Ø97
C=120	C=140

Installation

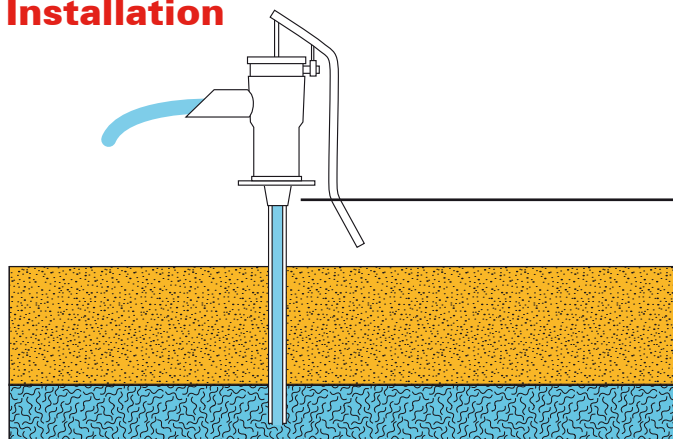

Mouting on



Seals set



Square set



Feet set



RETRO

Hand Water Pump

- + Classically French styled
- + stylish ornamental garden feature
- + Few installation
- + Easy to use

Data

Pump body in cast iron
Adjustable hand lever in cast iron
Self-priming up to 8 m
Plunger 80 mm
Flow rate per stroke : 0,7 l
Flow rate : 30 à 40 l/mn
Weight : 22 Kg

Installation

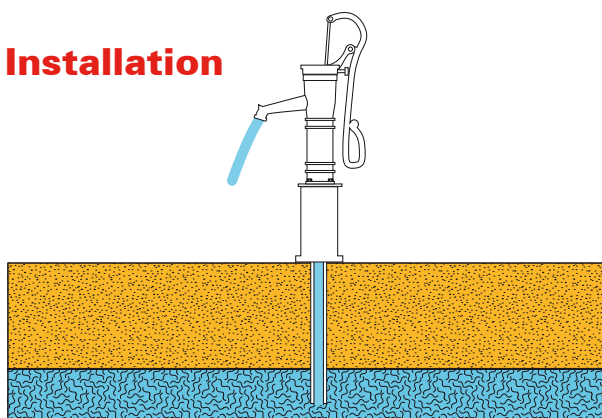

Options

Exotic wood board, width 245 mm
Cast iron sink, 400 x 310 mm
Extension feet, height 350 mm

Dimensions

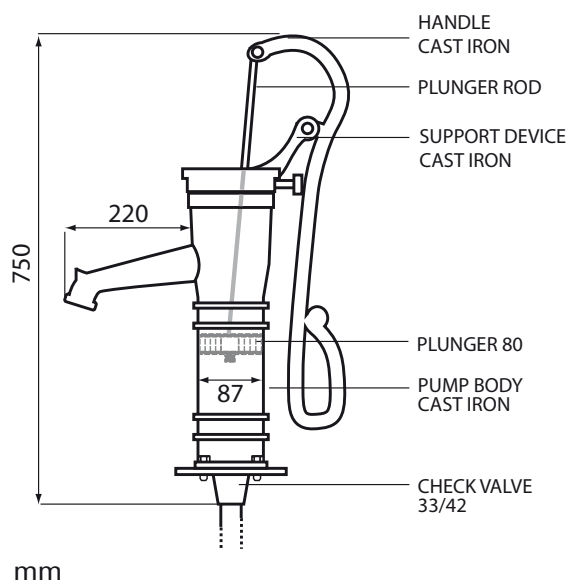

Inlet diameter : 33/42
Plunger run : 140



Instruction

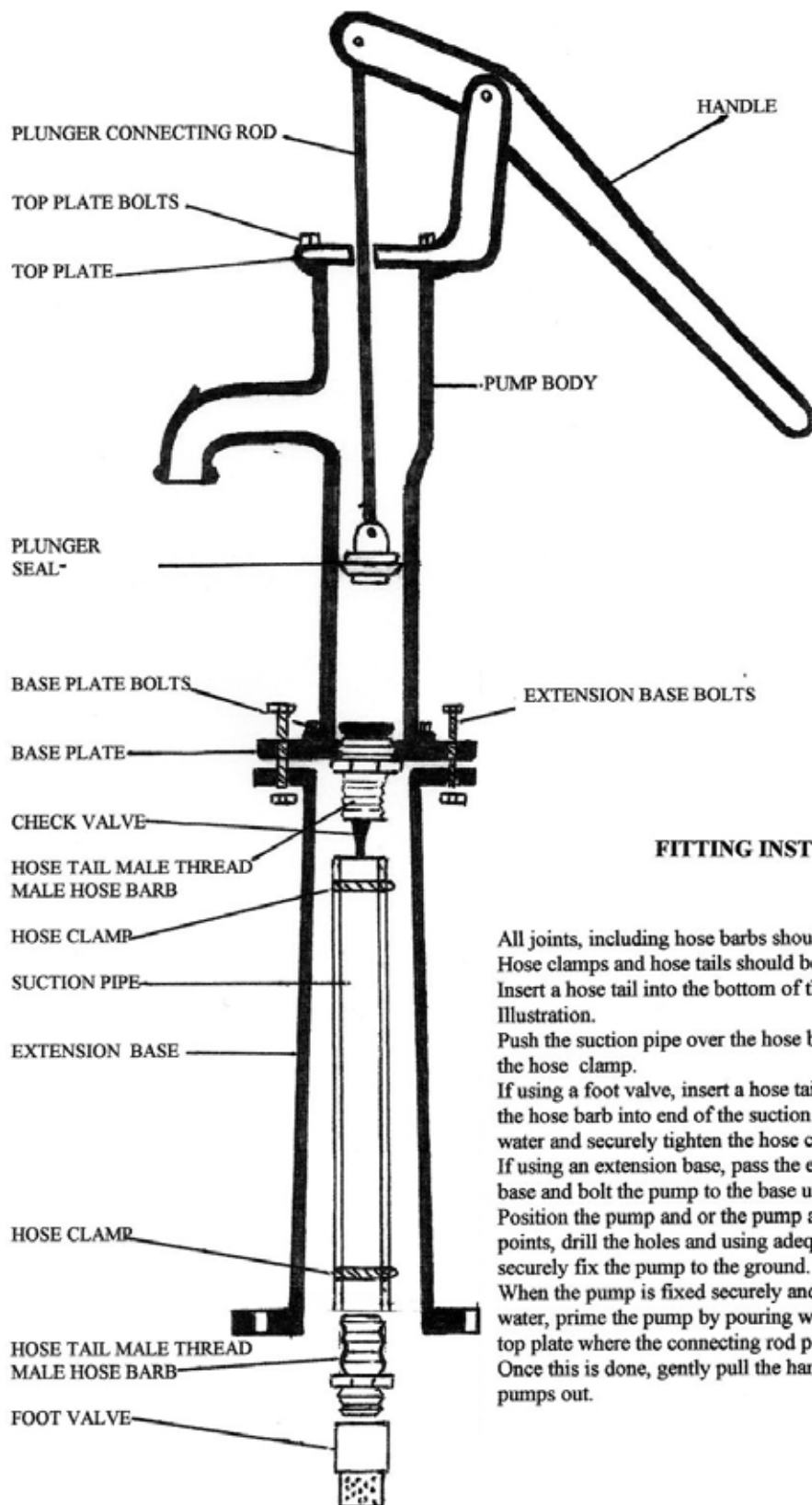

FITTING INSTRUCTIONS

All joints, including hose barbs should be made using PTFE tape. Hose clamps and hose tails should be firmly secured.

Insert a hose tail into the bottom of the pump as shown in the illustration.

Push the suction pipe over the hose barb and securely tighten the hose clamp.

If using a foot valve, insert a hose tail into the valve, then push the hose barb into end of the suction pipe that is going into the water and securely tighten the hose clamp.

If using an extension base, pass the end of the hose through the base and bolt the pump to the base using the 4 bolts and nuts. Position the pump and or the pump and base, mark the fixing points, drill the holes and using adequate fixings (not supplied) securely fix the pump to the ground.

When the pump is fixed securely and the suction pipe is in the water, prime the pump by pouring water through the slot in the top plate where the connecting rod passes through. Once this is done, gently pull the handle up and down until water pumps out.